

NOTE:

ALL LAND OTHER THAN THE PROPERTY UPON WHICH THE INDIVIDUAL UNITS ARE SITUATED, THE STORMWATER MANAGEMENT TRACTS AND THE LIFT STATION TRACT, SHALL BE CONSIDERED COMMON PROPERTY.

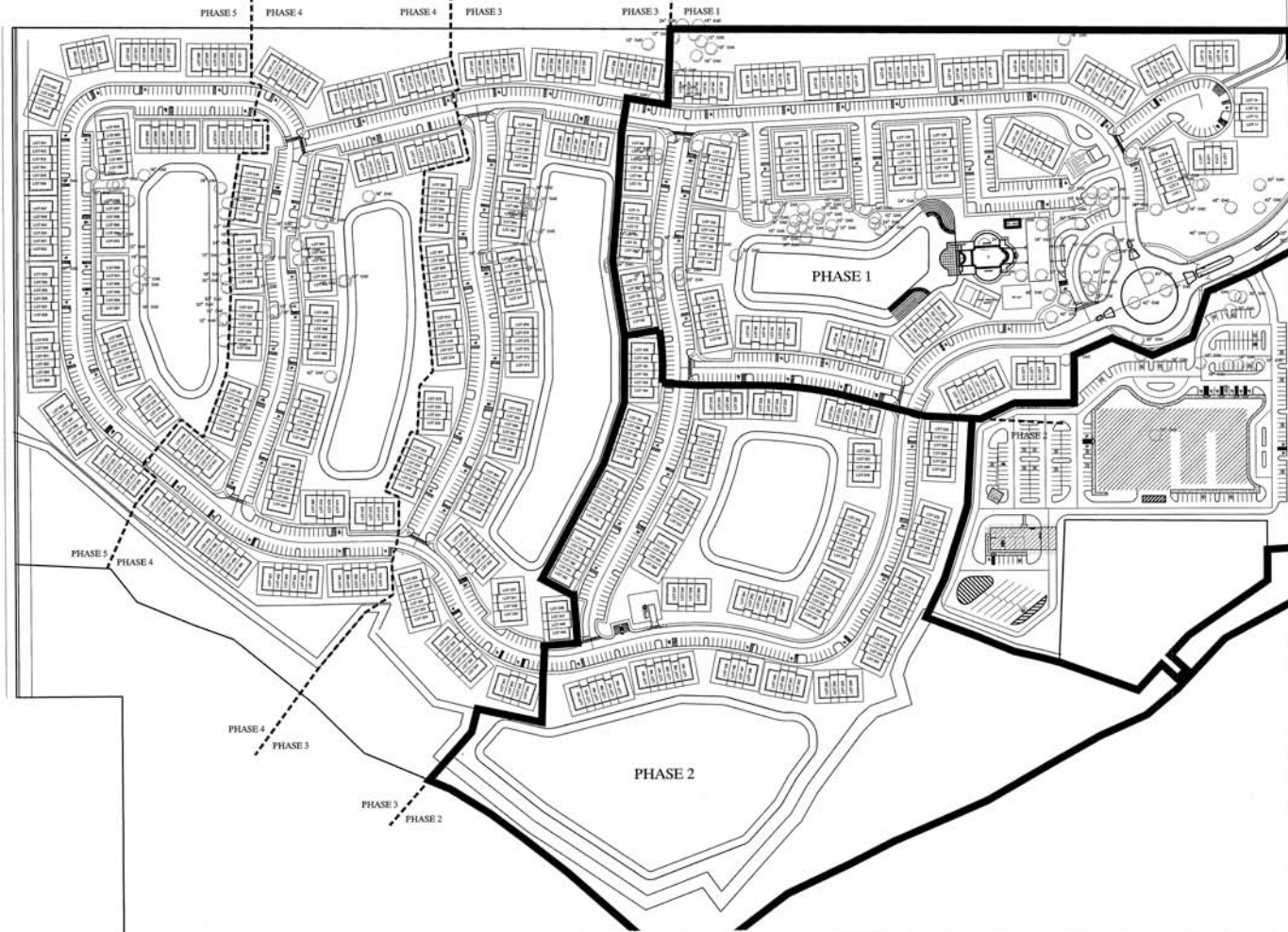

SITE MODIFICATIONS

- ADDITION OF TWO (2) VACUUM CAR WASH BAYS ADJACENT TO LIFT STATION.
- ADDITION OF COVERED DROP-OFF AREA FOR CLUBHOUSE.
- REMOVAL OF TWO (2) 18' OAKS, ONE (1) 30' OAK AND ONE (1) 30' OAK.
- MODIFICATION OF POND CONTOURS TO ACCOMMODATE POOL DECK OVERLOOK.
- MODIFICATION OF SIDEWALKS SOUTH AND EAST OF CLUBHOUSE.
- REMOVAL OF ONE (1) HANDICAP AND THREE (3) STANDARD PARKING STALLS AT CLUBHOUSE.
- REMOVAL OF TWO (2) STANDARD PARKING STALLS AND THE ADDITION OF ONE (1) HANDICAP PARKING STALL NORTH OF THE CLUBHOUSE.

REVISED PARKING TOTALS	
TOWNHOME PARKING REQUIRED	1,231 SPACES
HANDICAP PARKING REQUIRED (1 PER 100 OVER 1000 SPACES)	30 SPACES
TOTAL PARKING REQUIRED	1,266 SPACES
TOWNHOME PARKING PROVIDED	1,232 SPACES
HANDICAP SPACES	132 SPACES
TOTAL PARKING PROVIDED:	1,354 SPACES

RD DEVELOPMENT GROUP INC.
conceptualize a reality
 Cert. of Authorization Number: 000028206
 P.O. Box 701509, St. Cloud, FL 34770-1509
 email: mail@rdgi.com

address:
 Real Deal Development Group Inc.
 Post Office Box 701509
 St. Cloud FL 34770-1509
 Phone: (407) 957-0019
 Fax: (407) 892-0697
 E-mail: mail@rdgi.com

Scale: 1" = 100'
 Date: September 19, 2005

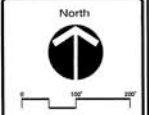

location:
 Osceola County, Florida
 Sec 26, Twn 25 S, R 29 E

project:
Heritage Key Villas

client:
FLPRD, LLC

drawing file

Master Site Plan

sheet number:
1 of 1

THIS DOCUMENT IS THE PROPERTY OF REAL DEAL DEVELOPMENT GROUP INC. AND IS NOT TO BE REPRODUCED OR TRANSMITTED IN ANY FORM OR BY ANY MEANS, ELECTRONIC OR MECHANICAL, INCLUDING PHOTOCOPYING, RECORDING, OR BY ANY INFORMATION STORAGE AND RETRIEVAL SYSTEM, WITHOUT THE WRITTEN PERMISSION OF REAL DEAL DEVELOPMENT GROUP INC.